

User Manual

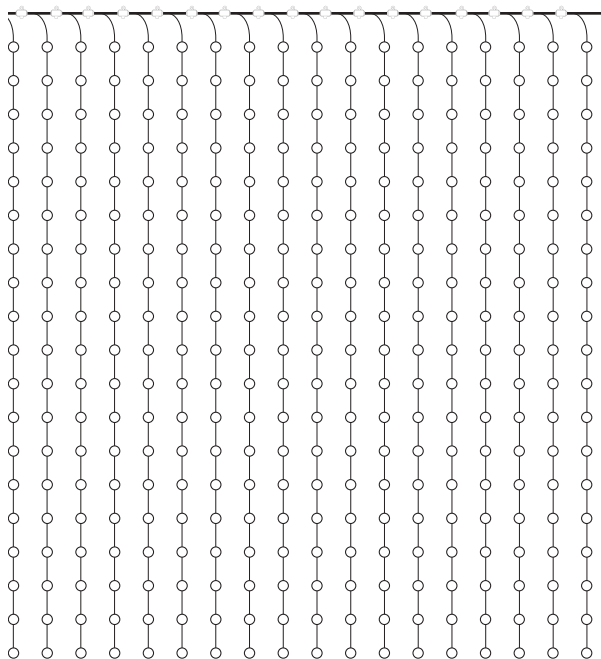

AmbiColour Smart Light Curtain

CSH-DIYCL-231

WHAT'S IN THE BOX

- Smart light curtain
- Switch controller
- Power adaptor

You may also need:

- Smartphone or tablet with Bluetooth and connected to 2.4GHz band Wi-Fi network
- Password for Wi-Fi network

WARNING: Keep out of reach of infants and young children; use under parental supervision.

INSTALLATION

! INDOOR USE ONLY

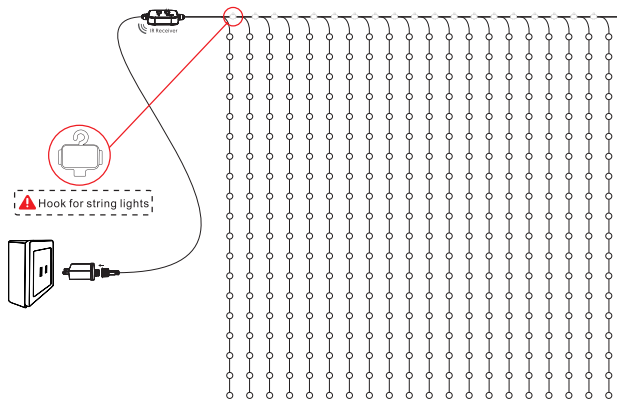

1. Use the hooks at the top of the Smart Curtain Lights to hang it.

NOTE: Do not cut the curtain lights to alter its length.



INSTALLATION

continued...

2. Connect the power cord of the controller to the power adapter, and twist the cap to secure it.

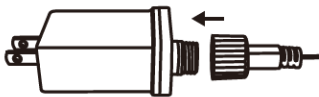

3. Connect the power adapter to a power source and press the Power button on the controller to turn on the lights.

CONTROLLER - OVERVIEW

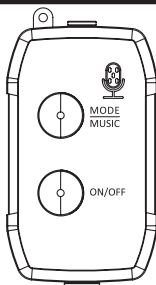

MODE/MUSIC:

- Hold down for 3 sec. each to switch between scene, monochrome and music modes.
- In music mode, press to switch between 4 music modes.
- In scene mode, press to switch between animation modes.
- In monochrome mode, press to switch between 16 monochrome modes.

ON/OFF:

- Press to turn on and off the lights.
- Hold down for 5 sec. to enter pairing mode.

CONNECT WITH THE APP

1. Get the app

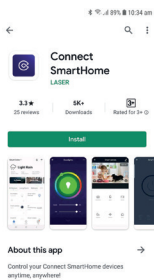

2. Register or login to app

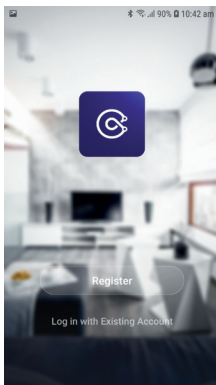

CONNECT WITH THE APP

continued...

3. Recommended app settings

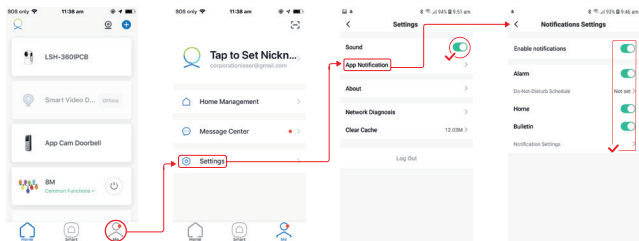

4. Turn on Bluetooth and Wi-Fi on your smartphone. Make sure you are connected to a 2.4GHz Wi-Fi access point.

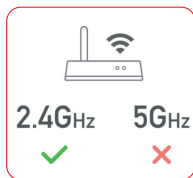

Only 2.4G Wi-Fi
networks are supported

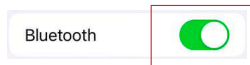

CONNECT WITH THE APP

continued...

5. Connecting lights to app

TIP
If light not flashing, hold down ON/OFF button for 5sec.

All Devices

- 1 +
- 2 Add Device
- Create Scene

Smarter Space
Smart Constellation Splici...

Add Device

1 +

AmbiColour Smart Lig...
Tap to add this device

Select 2.4 GHz Wi-Fi Network and enter password.

If your Wi-Fi is 5GHz, please set it to be 2.4GHz.
[Common router setting method](#)

1 Wi-Fi - 2.4Ghz

2 Connect Smarthome

3 Next

Reset the device

1 On/Off x3

If the light is blinking rapidly, pls skip the

- 1 Confirm the indicator is blinking or breathing
- 2 Next

Reset Device Step by Step

Add Device Done

1 device(s) being added

AmbiColour Smart Lig...
Being added

Add Device Done

1 device(s) added successfully

AmbiColour Smart Lig...
Added successfully

0 device(s) being added

CONNECT WITH THE APP

continued...

6. Using the light (with app)

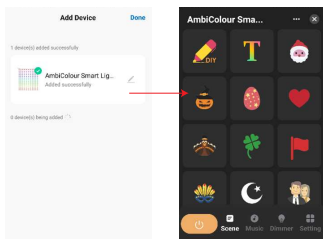

7. Remove the light from the app

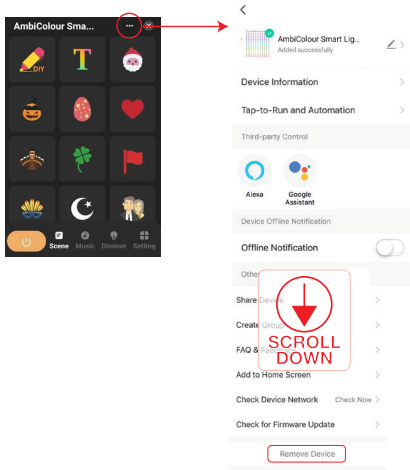

TROUBLESHOOTING

THE SMART CURTAIN LIGHTS DO NOT APPEAR ON THE APP

- If the controller's light is not blinking rapidly, hold down the power button for 5 seconds until the light flashes rapidly to reset it.
- Ensure Bluetooth and Wi-Fi are enabled on your smartphone.
- Ensure the Wi-Fi signal is strong where it is being installed.
- Make sure you are connected to a 2.4GHz Wi-Fi network. Most modems/routers support both 2.4GHz and 5GHz bands and may use the same Wi-Fi network name (SSID) for both bands. Log into the router's settings and check:
 - Is 2.4GHz band enabled?
 - If both 2.4GHz and 5GHz bands are using the same SSID, find the settings that allow you to separate the 2.4GHz and 5GHz bands. Usually, there will be an option to configure each band individually. Change the SSID for one or both bands to make them distinct.

TROUBLESHOOTING

continued...

For instance, “NetworkName_2.4GHz” and “NetworkName_5GHz”.

- If you are using Telstra Smart Modem, refer to the following guide to resolve band steering issues: <https://www.laserco.com.au/Telstra-NBN-Gen-Smart-Modem-Fix>

WARNINGS AND CAUTIONS

- 1.** Keep this product out of reach of infants and young children. Children should only use it under adult supervision.
- 2.** Don't leave the power cord on the floor to prevent tripping.
- 3.** Avoid using or storing the device in humid places such as bathrooms, as well as in dust or dirt. Doing so may cause damage to components and electronics.
- 4.** Don't put the device in a hot place as it can reduce its lifespan and damage plastic components.
- 5.** Do not hit or throw the device with force, as this could damage its delicate structure.
- 6.** Avoid using strong chemicals, cleaners, or detergents to clean the device.
- 7.** If you detect an unusual smell, heat, discoloration, deformation, etc., please stop using the device right away.
- 8.** The lights may not work properly if radio frequency interference is present during operation.

SPECIFICATIONS

Dimensions	Curtain lights (WxH): 2x2m
Power adaptor	AC 100-240V, 50/60Hz
Wi-Fi Standard	802.11 b/g/n
Wi-Fi Frequency	2.4GHz
Bluetooth version	5.0

Visit our website

www.connectsmarthome.com.au



Check us out at

